

# SEBO Airbelt K Owner's Manual

## Airbelt K vacuum user's guide

Vacuum Motor - 1250 watts (10.6 amps)

Filter Bag Capacity - .8 gallons

Motor Protection - Thermal Cut-Out

Technical details may be subject to change.

Water Lift (at motor) - 110 inches

Sound Level - 63 dB

Cord Length - 20 feet

Airflow (at motor) - 120 CFM

Body Weight - 12 lbs

Range - 31 feet

## Important Safety Instructions





### READ ALL INSTRUCTIONS BEFORE USING THIS MACHINE

#### When using an electrical appliance, basic precautions must always be followed.

To reduce the risk of electric shock, this vacuum cleaner has a polarized plug; one blade is wider than the other. This plug will fit in a polarized outlet only one way. If the plug does not fit fully in the outlet, reverse the plug. If it still does not fit, contact a qualified electrician to install the proper outlet. Do not change the plug in any way. Connect only to the outlet type specified on the serial number plate underneath the machine.

#### SAVE THESE INSTRUCTIONS.

#### **WARNING: To reduce the risk of fire, electric shock, or injury:**

- Do not leave vacuum while plugged in. Unplug from outlet when not in use and before servicing.
- Do not use outdoors or on wet surfaces.
- Do not use near small children or pets. Do not allow to be used as a toy. Use of this product by children should always be supervised by an adult.
- Use only as described in this manual. Use only manufacturer recommended attachments.
- Do not use with a damaged cord or plug. If vacuum is not working as it should, has been dropped, damaged, left outdoors, or dropped into water, take it to a SEBO service center.
- Do not pull or carry by cord, use cord as a handle, close a door on cord, or pull cord around sharp edges or corners. Do not run vacuum over cord. Keep cord away from heated surfaces.
- Do not unplug by pulling on cord. To unplug, grasp the plug  not the cord.
- Do not plug in if switch is in the I (ON) position.
- Do not use outlets above counters to plug in vacuum  damage to items in the surrounding area could occur.
- Always carry the vacuum over steps and sills.
- Do not handle plug or vacuum handle with wet hands.
- Do not put any object into vacuum openings. Do not use machine with any openings blocked. Keep openings free of lint, hair, and anything that may reduce air flow.
- Do not reuse filter bags or wash the filters.
- Do not remove any screws from vacuum.
- Do not vacuum up anything that is burning or smoking, such as cigarettes, matches, or hot ashes.
- Do not use vacuum without filter bag and/or filters in place.
- Turn off all machine controls before unplugging.
- Use extra care when cleaning on stairs.
- Do not use machine to vacuum up flammable or combustible liquids such as gasoline or use in areas where they may be present.
- Machines can cause a fire when operated near flammable vapors or materials. Do not operate this vacuum near flammable fluids, dust or vapors.
- Maintenance and repairs must be done by qualified personnel.
- Use only original SEBO replacement parts.
- Do not use vacuum as a step.
- If vacuum is used on plush carpet or carpet with thick padding, do not leave machine standing in one place with machine turned on.
- While the vacuum is in use, the power cord should be unwound from the cable reel at least two thirds of its length. Hold plug when rewinding onto the cord reel. Do not allow plug to whip while rewinding.
- Keep hair, loose clothing, fingers, and all parts of body away from vacuum openings and moving parts. Do not place fingers or other body parts under vacuum unless it is unplugged.
- Do not place the power head over rug or carpet edges.

- The vacuum has a manual reset thermal protector. The protector is reset by switching off the vacuum. The thermal protector needs some time to cool down after switching off! Check the vacuum for air blockages or mechanical failures before switching on.
- Store the vacuum in a dry place at room temperature. When the vacuum is not in use, you should rewind the cord onto the cord reel
- Any other servicing should be performed by an authorized service representative.
- The hose contains electrical wires. Do not use if damaged, cut, or punctured. Avoid picking up sharp objects.
- Always unplug vacuum before connecting or disconnecting either hose or power head.
- Use a SEBO power head only in combination with a SEBO vacuum cleaner.
- Do not connect power head to a malfunctioning or damaged vacuums.

## Product Features

### Sebo Vacuums Save Money!

Sebo vacuums are the highest quality machines available. In fact, if properly maintained, Sebo vacuums can save ordinary residential users hundreds of dollars by providing excellent performance for ten to fifteen years or more. Typical vacuums perform poorly and usually do not last beyond two years. So, in the long run, Sebo vacuums cost less money than the five to six other vacuums purchased during that time period.

### Outstanding Warranty Coverage

Sebo is confident about the quality of all its vacuums. Therefore, all models include a five-year warranty on the motor and all non-wear parts and a 1-year warranty on labor charges.



### Brush Obstruction Light & Auto Shut Off

A warning light will quickly flash, the brush roller will immediately stop spinning and the vacuum will shut off, if an obstruction becomes jammed in the brush roller. The user should turn the power switch off, unplug the machine, and immediately remove the obstruction. If the user restarts the machine without removing the obstruction, the power head will again shut off and the amber light will turn on. This prevents the belt from breaking and protects the motor from damage.



### Bag Full or Clog Light & Auto Shut Off

A warning light will illuminate and the machine will automatically shut off, when it senses a full bag, a clog in the airflow pathway, or an excessively dirty micro filter. If the vacuum's airflow pathway becomes restricted due to a full bag or the existence of a clog, the amber "BAG FULL OR CLOG" light (located on top of the canister near the ON/OFF power control knob) will illuminate. If the user ignores this warning, the suction motor will heat up due to the lack of cooling provided by the airflow. Once the motor reaches a certain temperature it will shut off to protect itself from damage. The user should turn the switch off, unplug the machine and immediately insert a new bag or remove the clog (to remove a clog, refer to the Clog Removal section). After about 30 minutes, the motor will have cooled and the vacuum can be restarted. If the airflow is still restricted, the "BAG FULL OR CLOG" light will again illuminate and the machine will shut off. This feature prevents damage to the motor due to overheating.



### Incorrect Height Setting or Brush Deterioration Light

To ensure optimum cleaning at all times, a warning light will illuminate to indicate when the brush height is set too high for effective cleaning, or when the brush roller should be replaced due to excessive wear.



### Anti-Allergy Hospital-grade, S-class Filtration

An excellent choice for users with allergies or asthma. Certified by leading Allergy foundations in Europe, the AIRBELT K vacuums provide the user with S-class filtration of 99.9% of particles to 0.3 microns. This is accomplished by the Sebo three-step filtration system. First, the three-layer full-size filter bag (a) collects the vast majority of the debris. Then, the remainder of the particles are collected by the hospital-grade micro filter (b). Finally, the micro-exhaust filter (c) cleans the exhaust air that the vacuum emits. The air belt disperses the filtered exhaust air around the canister which provides quiet, gentle air flow. Sebo's unwavering attention to the complete sealing of the machine ensures no dirt escapes around the micro filters.



### Liberation from bagless! Sebo Bags are Hygienic

The three-layer filter bag is an integral part of Sebo's filtration system because it effectively contains nearly all dirt captured by the vacuum. And Sebo bags can be sealed when full, so no dust can escape into the air during disposal. In contrast, a lot of dust becomes airborne when emptying the dirt containers of bagless vacuums, and their micro filters quickly clog and must be replaced often, or a loss of suction will occur. And bagless vacuum micro filters are expensive, usually costing much more than Sebo's filter bags.



### Micro Filters are Inexpensive and Easy to Change

Unlike most other vacuums, Sebo's replacement micro filters are reasonably priced and can be easily changed in seconds, without any tools. And the micro filters last a long time before replacements are necessary because nearly all dust particles and debris are first captured by the three-layer filter bags.



### Remarkably Quiet Operation

A Sebo vacuum is so quiet, it will not scare pets, and the feature will be appreciated by family members.

SEBO three-step filtration system

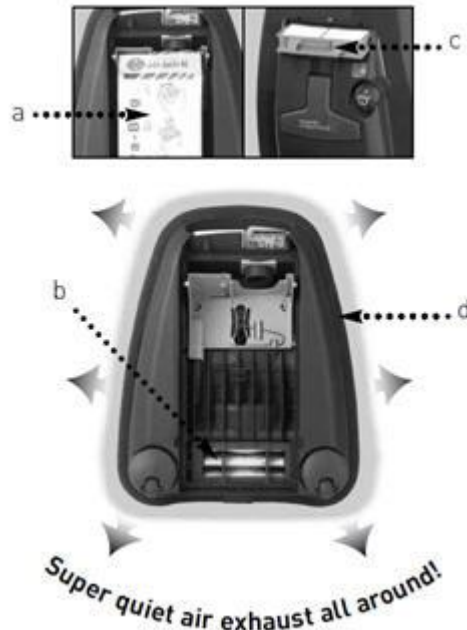

## Designed for All Floor Surfaces.

### AIRBELT K3: Five Power Head Choices

The AIRBELT K3 has an electrified telescopic tube designed to accommodate any choice from the following five power heads: ET1, ET2, ETH and DISCO. Each power head has unique features and benefits, but all power brushes are designed to provide thorough brushing for optimal cleaning of carpets. The DISCO power head enables the vacuum to polish hard floors.



K3 with DISCO

### AIRBELT K3: Cleaning Dimensions

The ET1 power head is 12 inches wide, with a cleaning width of 10 1/2 inches, and the ET2 is 14 3/4 inches wide, with a 13 inch cleaning width. The ETC power head is 14 inches wide, with a 12 1/2 inch cleaning width, and the ETH is 11 3/4 inches wide, with an 11 1/2 inch cleaning width. The DISCO is 13 inches wide, with an 11 3/4 inch polishing width.

### Both Carpet and Hard Floor Cleaning

With a power brush to clean carpets and a parquet nozzle to clean hard floors, the AIRBELT K3 provides all the flexibility needed to care for a variety of floor surfaces. The parquet nozzle comes standard. The K3 vacuum can morph into a hard floor polisher, by adding a SEBO DISCO head.

### High Quality Telescopic Tube and Hose

On the K3, the power cord is built inside the telescopic tube and suction hose. This eliminates unsightly external wires and enables unobstructed and convenient handle height adjustment.

### Variable Power Control on Handle

The vacuum's suction power can be adjusted from 0 to 1,250 watts by a slider switch conveniently located on the handle.



### Midsized Canister Vacuum

The SEBO AIRBELT K3 and K2 are considered mid size canister vacuums, which means they are machines medium in size that offer midsized, onboard attachments and a midsized filter bag with a dirt capacity of .8 gallons. The K machines also weigh four pounds less than the C machines.

### Three Onboard Tools

The vacuum comes standard with a crevice tool, dusting brush and upholstery nozzle. The dusting brush is mounted on the telescopic tube, and the crevice and upholstery nozzles are on the canister. Many optional accessories are also available.

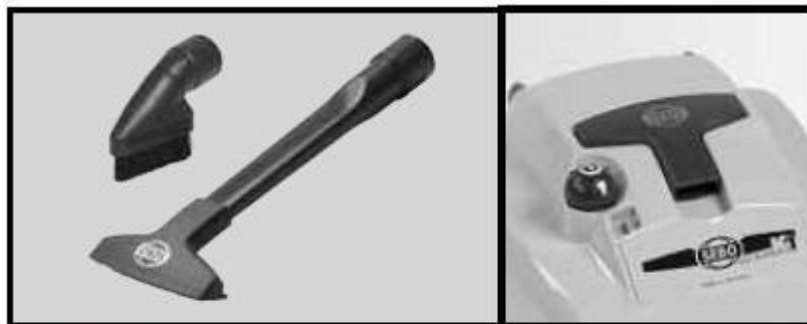

Dusting Brush    Crevice Nozzle  
Upholstery Nozzle

### Brushless Cleaning Capability

The ET1 or ET2 power heads can provide gentle, brushless cleaning of delicate rugs or hard floors because the brush roller may be switched off, but suction will continue.

### Four-level Manual Brush Height Adjustment

The brush height can be adjusted up or down for optimum cleaning.

### Quick-release Connections

The AIRBELT K models allow for quick and convenient connection of telescopic tubes, power brush

heads, accessory cleaning heads and onboard tools.

### Shock Absorber Provides Furniture and Wall Protection

The AIRBELT bumper that surrounds the K canisters acts as a protective barrier. The soft foam bumper with its durable covering protects furniture, walls and the vacuum itself from damage during use.



### Personalized Vacuums

AIRBELT canister vacuums can be personalized with a replacement AIRBELT bumper cover available in eight patterns and colors.

### Powerful Vacuum Motors Provide Excellent Cleaning

The canister suction motor is 1,250 watts, and the power head motor is 175 watts (ET1), for a total of 1,425 watts.

### Comfortable Ergonomic Handle

The AIRBELT handles are ergonomically designed and positioned to reduce wrist and arm fatigue. For extra comfort, an additional swivel is built into the handle-to-hose connection.

### Rubber Coated Wheels and High Quality Castors

The quality of the wheels and castors on SEBO canisters prevent damage to floors and rotate 360° for easy maneuverability. Large Operating Range A 31-foot operating range saves time because it minimizes the number of electrical outlets needed during use.

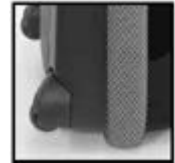

### AIRBELT K2:

The SEBO AIRBELT K2 is a straight suction vacuum. As a result, it differs from the AIRBELT K3 in the following two ways:

- **Can Not Use a Power Brush** The AIRBELT K2 does not have an electrified telescopic tube and hose; therefore, it does not accommodate an electrified power brush. Instead, it comes standard with a Turbo Nozzle (an air-driven brush head) for cleaning rugs and carpet. It also comes standard with a Parquet cleaning hard floors.



Nozzle for

- **Variable Power Control on Canister Body** Because the AIRBELT K2 does not have an electrified hose and handle, its variable power control switch is located on the canister body, not the handle.

## Optional Power Heads for the AIRBELT K3

Deep clean your carpet with a SEBO power head, or polish your hard floor with a SEBO DISCO Ultra-High-Speed floor polisher! SEBO power heads and the DISCO polisher are virtually maintenance free, and their electronic overload protection feature extends belt life by automatically shutting off power, if a brush roller or polisher pad jams.

**ETH Power Head** (11 3/4" wide, 11 1/2" cleaning width) new design offers dual-edge cleaning and a manual brush pressure control, for cleaning from one type of flooring to another. The steering mechanism built swivel neck helps to easily clean around obstacles. It also has a brush height wear warning light.



**The SEBO**  
Its patented optimal into the and brush

**The SEBO ET1 (12" wide, 10 1/2" cleaning width) and ET2 Power Heads (14 3/4" wide, 13" cleaning width)**

These power heads deliver cleaning flexibility because their brush action aggressively cleans carpeting, and the brush may be switched off to clean hard floors and delicate rugs. The steering ability of the swivel necks help to easily clean around obstacles, and their L-shaped heads provide maneuverability around furniture and under cabinets. They also have brush height and brush wear warning lights.

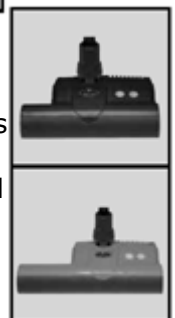



## The SEBO DISCO (13" wide, 11 3/4" polishing width)

It's never been easier to make hard floors shine! The Sebo Disco floor polisher can both vacuum and polish, for a super-gloss finish. It can be attached to the Felix uprights or to the Airbelt C or K canisters. Its suction removes fine dust (dust from fully dried floor polishing product) during polishing, and the 2,000 RPM disc speed will create a high-gloss shine for a fantastic hard floor finish. Additional Disco features include automatic height adjustment, automatic safety shut-off caused by blockages or other reasons, a soft bumper to protect walls and furniture, a highly maneuverable swivel neck, and three rubber coated castors to protect the floor.



## Optional Attachments, Accessories, Bags & Filters

In addition to the standard onboard tools, a variety of optional attachments are available. The nine foot extension hose (extends suction hoses) and the 19inch extension tube are very popular because they create useful tools for cleaning stairs and out of reach areas. These two items are sold separately or as part of multiple item attachment kits. Another popular attachment is the hand held turbo brush for removing pet hair from upholstery.

SEBO filter bags can be purchased in boxes of eight and filters are sold separately. Also, bags and filters can be purchased together in model specific kits called ♦Service Boxes.♦ SEBO bags, filters and accessories are reasonably priced and widely available.

To create a fresh scent while vacuuming, ♦SEBO FRESH♦ is available. To use, deposit a scented stick in the filter bag.

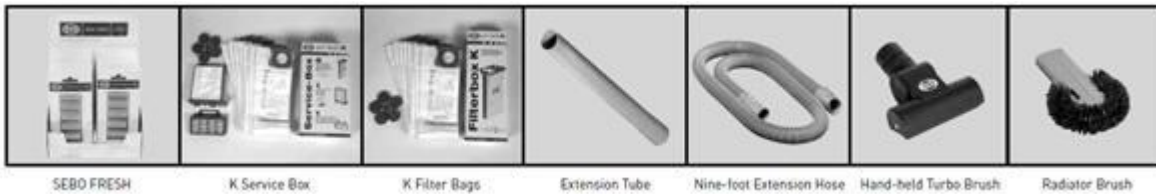

## Operating Instructions - All K Vacuums

### Starting the Machine

Before turning on your canister, make sure that you have a firm hold on the handle grip to keep the machine from moving forward.

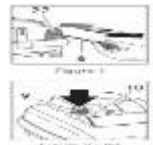

1. With the canister main power control knob in the OFF position, grasp the plug and pull the power cord out from the power cable recess. The power cord should be unwound from the cable reel at least two-thirds of its length. Note: do not over-extend the cord.
2. Plug the polarized power cord into a 120 volt wall outlet located near the floor.
3. Press the main power control knob on the base of the canister gently with your foot or hand. The green light will illuminate indicating that the power is on (K3 model only).

### Suction Control

K2 users - the suction control dial is located on the top side of the canister on the power control knob. Rotate the dial counter-clockwise for maximum suction. Rotate clockwise to reduce suction for vacuuming curtains or delicate fabrics.

K3 users - for information on suction control, see below.

### Operating the Machine

Adjust the telescopic tube to the correct height by pushing the slide button and gently pulling the tube out to lengthen, or pushing it in to shorten. Release the slide button to lock the tube to the adjusted height.

When changing heads, always switch the vacuum off with the power control knob, and then unplug the power cord.



Figure 1-K2

The "bag full or clog" light works correctly only at full power. At lower power levels, the "bag full or clog" light may illuminate incorrectly. Check the status of the filter bag regularly at full power. If the light remains illuminated at full power, and the filter bag is not full, check for clogs.

To retract the cord, switch the vacuum off, unplug it from the outlet, then gently pull on the cord near the plug recess and the mechanism will automatically rewind. Before rewinding the cable, always switch off and unplug the vacuum. Hold the plug while rewinding the cord into the cord reel. Avoid letting the plug whip while rewinding.

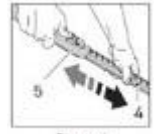

The vacuum can be stored with the canister in a horizontal or vertical position. The Parquet nozzle, Combination nozzle and Turbo nozzle have a parking tab located on the front of the neck. Insert the parking tab into the upper side of the parking groove and slide down firmly. For vertical storage, or for easy carrying, use the parking slot on the underside. For horizontal storage, use the parking slot on the end of the canister.

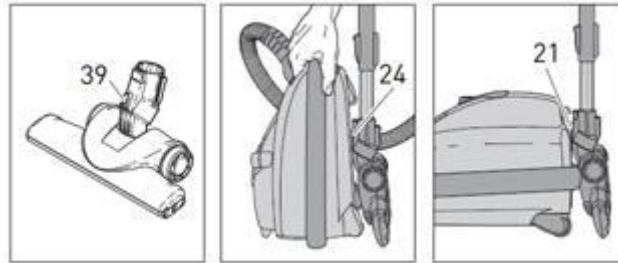

Figure 5

Figure 6

Figure 7

**Warning** - The quality, condition, coating, texture, age and manufacturing technique of all floor surfaces vary. Therefore, vacuums with rotating brushes, including your Sebo, may damage some floor coverings or surfaces. Some types of high-gloss hardwood floors, cushion vinyl, berber carpets, long shag, and delicate or hand-woven carpets are particularly vulnerable for damage by rotating brushes. When possible, consult the materials supplied by your flooring manufacturer for information on proper upkeep and cleaning. **To ensure that your new Sebo vacuum cleaner is compatible with your floor, please test the vacuum cleaner on each type of flooring surface in a small inconspicuous area to determine if any damage occurs. If damage occurs, stop using the vacuum cleaning immediately!**

## Additional Operating Instructions for K3 with Power Head

**Please refer to your power head owners manual for more information.**

**Starting the machine and suction control**  
canister, make sure that the vacuum handle is in

1. With the canister main power control the power control slider on the handle in power cord out from the base of the should be unwound from the cable reel at Note: do not overextend the cord.
2. Plug the polarized power cord into a 120 the floor.
3. Press the main power control knob on the your ETH power head ET1 power head will illuminate indicating that the power is on.
4. Slide the Power Control Slider to the ON position (the slider will **click** when it is pushed out of the OFF position). It will then slide freely between 0 suction and MAX suction. Set the slider to the suction desired. Release the foot pedal on the ET1 or ET2 power head or, for the ETH power head, lower the handle.



Figure 8

Before turning on your its upright locked position.

knob in the OFF position, and the OFF position, pull the canister. The power cord least two thirds of its length.

volt wall outlet located near base of the canister gently with foot or hand. The green light

## Operating the Machine

When the power head is on with the handle in the upright locked position, the brush roller will not spin.

To release the ET1 or ET2 power head from the upright locked position, press down on the foot pedal and lower the handle into the normal operating position and push the button on the top of the power head to engage the brush roller. The green light on the power head will illuminate.

To release the ETH power head from the upright locked position, gently place your foot on the power head for leverage and lower the handle into the operating position. The brush roller will then start spinning. The amber indicator light may flicker for a few seconds when you lower the handle - this is normal.

The handle can be lowered to a horizontal position useful for vacuuming under beds.

You may adjust the suction control with the power control slider as you vacuum different surfaces or when using the accessory tools. For optimal cleaning and brushing, operate the machine at the maximum suction power setting and push the power head slowly over the carpet.

When the canister's main power control knob is in the ON position, you may turn the power head off and on with the power control slider. To turn the power head off using the power control slider, pull the slider to 0 suction, then continue pulling the slider up until it clicks into the OFF position. The green power head light will then shut off (the green light on the canister will remain illuminated until the vacuum is powered off using the main power control knob).

**Always turn the power off on both the canister and the power head when changing heads or unplugging the vacuum.** Slide the power control slider on the power head to its OFF position, press the power control knob on the base of the canister gently with your foot or hand, then unplug the canister to completely shut down the power when changing heads or storing the vacuum.

To retract the cord, switch the vacuum off, unplug it from the outlet, then gently pull on the cord near the plug recess and the mechanism will automatically rewind. Before rewinding the cable, always switch off and unplug the vacuum. Hold the plug while rewinding the cord onto the cord reel. Avoid letting the plug whip while rewinding.

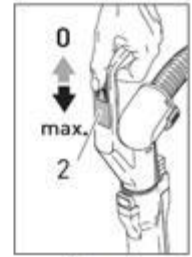

Figure 9

0 = Zero Suction  
MAX = Maximum Suction

ON position - Slide the slider down toward 0 suction till it "clicks" out of position.

OFF position - Pull the slider up to 0 suction then continue pulling the slider up until it "clicks" into the OFF position.

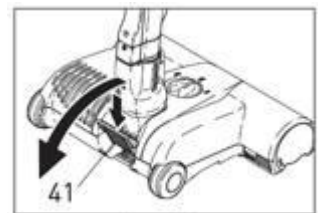

Figure 10a



Figure 10b

## Using the Telescopic Tube, Hose & Attachments

The telescopic tube is useful for vacuuming corners and hard-to-reach areas. You may use the telescopic tube without a brush, power head or remove a brush or power head, switch off the power control vacuum. Then, press the tool release button and pull the tube out. The crevice nozzle and dusting brush may be inserted onto the end of the tube. To use the upholstery nozzle, fit it onto the end of the crevice nozzle. It is not necessary to turn off the vacuum while switching the standard attachments (the crevice nozzle, upholstery nozzle or dusting brush). After use, switch off the power, unplug the vacuum and remove attachment. Reinsert the telescopic tube into the power head or brush, turning the tube if needed, until you hear it click into place.

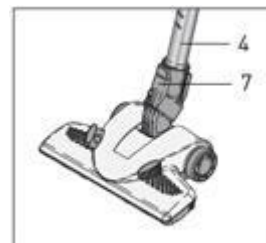

Figure 11

to-reach areas. You may use the telescopic tube without a brush, power head or remove a brush or power head, switch off the power control vacuum. Then, press the tool release button and pull the tube out. The crevice nozzle and dusting brush may be inserted onto the end of the tube. To use the upholstery nozzle, fit it onto the end of the crevice nozzle. It is not necessary to turn off the vacuum while switching the standard attachments (the crevice nozzle, upholstery nozzle or dusting brush). After use, switch off the power, unplug the vacuum and remove attachment. Reinsert the telescopic tube into the power head or brush, turning the tube if needed, until you hear it click into place.



**NOTE! K3 users with ETH, ET1 or ET2 power heads, please refer to your power head user's manual for more detailed instructions for connecting your power head.**

To use the hose without the telescopic tube, switch off the power and unplug the vacuum. Push the handle release button and pull the HANDLE out of the end of the telescopic tube. Do not try to separate the hose from the handle! Insert the crevice nozzle or dusting brush onto the end of the handle. To use the upholstery nozzle, fit it onto the end of the crevice nozzle. After use, switch off the power, unplug the vacuum and remove the attachment. Reinsert the handle into the telescopic tube making sure it is seated correctly and snap it into place.

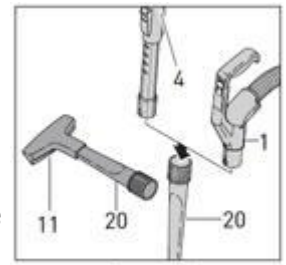

Figure 12

## Use and Maintenance of Brushes and Heads

**Always unplug vacuum from outlet before dismantling any part of machine!**

**To remove a brush or power head, switch off the power and unplug the vacuum. Then, press the tool release button and pull the tube out.**

**NOTE! K3 users with ETH, ET1 or ET2 power heads, please refer to your power head user's manual for more detailed instructions for operating and maintaining your power head.**

### Premium Parquet Nozzle

The parquet nozzle is specially designed for use on hard surfaces. The brush should be cleaned regularly. Remove the parquet nozzle from the telescopic tube to clean. Fibers and hair can be pulled out of the bristles manually, or vacuum the bristles with the telescopic tube. The brush strips are removable for cleaning and replacement.

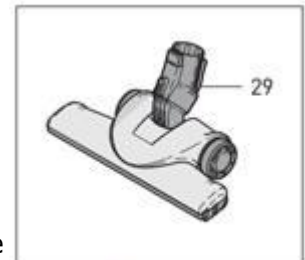

Figure 13

### Combination Nozzle

The Combination nozzle is adjustable for carpet or hard floors. To set for carpet, slide the up arrow button to the right until it clicks into place. The hard floor dusting brush will raise up allowing the head to move over the carpet. To set for hard floors, slide the down arrow button to the left until it clicks into place. The brush will lower to gently sweep your floors. The slider in Figure 14 is set in the position for hard floors. The brush should be cleaned regularly. Remove the Combination nozzle from the telescopic tube to clean. Fibers and hair can be pulled out of the bristles manually, or vacuum the bristles with the telescopic tube. The brush

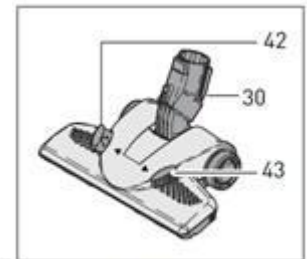

Figure 14

### Turbo Nozzle

an air-driven rotating brush for gentle brushing of carpets. The Turbo nozzle can be adjusted for high and low pile carpet. To adjust the head push the slider button to the right. For low pile carpet, push the left. The slider in Figure 15 is set in the low pile position. The rotating brush should be cleaned regularly. Remove the Turbo nozzle from the telescopic tube to clean. Remove fibers and hair from the brush manually.

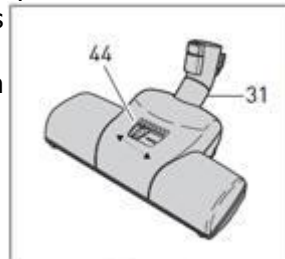

Figure 15

strip is removable for

The Turbo nozzle has an air-driven rotating brush. The Turbo nozzle can be adjusted for high pile carpet, the slider button to the right position. The rotating brush should be cleaned regularly. Remove the Turbo nozzle from the telescopic

# Vacuum Maintenance

**Always unplug vacuum from outlet before dismantling any part of the machine!**

## Changing the Filter Bag

To change the filter bag, set the canister upright (as shown in figure 13), press the cover release catch and lower the filter bag cover (26). Grasp the green filter bag sealing plate (46), slide the plate from the holder (48) and push the filter bag cap (47) on to seal the bag. Slide the sealing plate (46) of a new bag into the bag holder slots (48) and push it in firmly until it locks into place. Close the cover, making sure it snaps shut completely. You may find it convenient to store the bag cap inside the filter bag housing below the filter bag. Do not reuse the filter bags. Note: the nature of the contents of the filter bag will affect the point at which it needs changing. Fine dust may require an earlier change even though the bag is not full. Fluff or hair allows air to pass through easily, so the filter bag may overflow before the amber bag full light illuminates.

The bag full or clog light works correctly only at full power. At lower power levels, the bag full or clog light may illuminate incorrectly. Check the status of the filter bag regularly at full power.

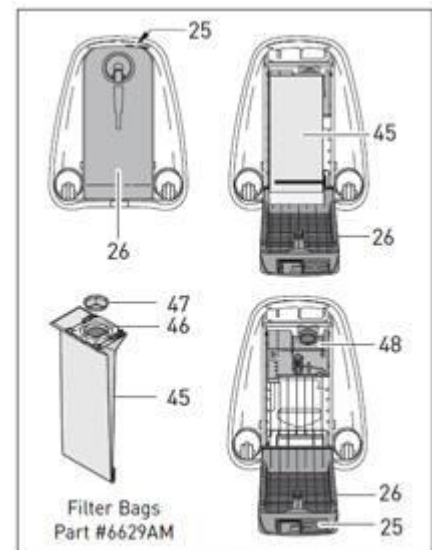

Figure 16

## Changing the Exhaust Filter

The exhaust filter (51) needs to be changed when it becomes extremely dirty or clogged with dust, or after approximately 10 to 20 filter bags have been used. To change the exhaust filter, set the canister flat on the floor as shown in figure 17. Remove the printed cover on top of the machine (14) by lifting the catch (49) in the upholstery nozzle recess (see inset, figure 17). Pull out the filter using the handle (50) and fit the new filter into the same position. The filter handle should point toward the upholstery nozzle when it is folded down. Fit the tabs on the bottom of the cover (14) into the grooves and snap the cover down firmly.

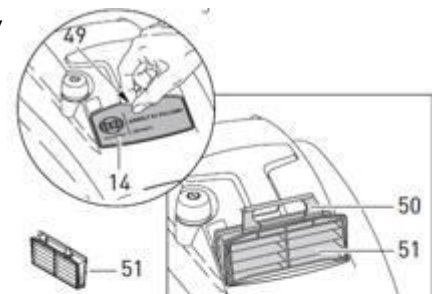

Figure 17

## Changing the Micro-Hygiene Filter

After 10 to 20 bags have been used, change the micro-hygiene filter (52). To remove the micro-hygiene filter, set the canister upright (as shown in figure 16). Press the cover release catch (25) and lower the filter bag cover (26). Remove the filter bag, then remove the cover by sliding it up and out of the grooves (53). Pull the old filter out (52) and slide the new filter into the same position. Replace the filter bag, then reinsert the cover by fitting the tabs into the grooves (53) on both sides and sliding it in and down. Push the cover closed, making sure it snaps shut completely.

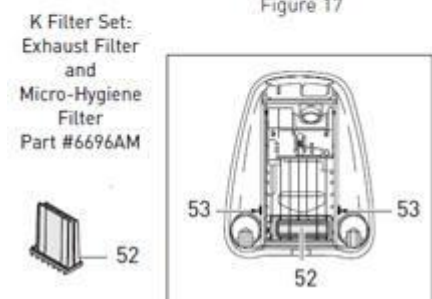

Figure 18

## Changing the AIRBELT

If damage occurs to the AIRBELT cover, it will need to be replaced. To remove the AIRBELT (15), pry off the clip (55) by inserting the tip of a slot-head screwdriver under the bottom side of the clip. Push downward on the screwdriver until the clip pops off. Grasp the end of the AIRBELT cover and pull the AIRBELT cover will peel off. The foam bumper (54) remains on the vacuum. To replace the AIRBELT, insert the side ribs of the AIRBELT into the grooves (56). Start at the back, insert rib into one groove (56), and while holding it down, stretch the AIRBELT cover around the foam (54) into the opposite groove (56). Continue around the vacuum. Secure the ends with the clip (55).

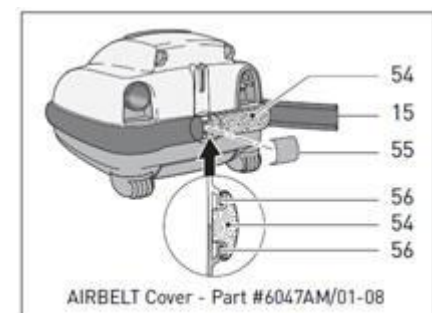

Figure 19

SEBO AIRBELT covers are available in a variety of colors and patterns. See your SEBO dealer for available selection.

**Note:** Never operate the vacuum with incorrectly attached filters or without filters, bag, AIRBELT or filter bag housing cover (26). Do not reuse filter bags. Do not wash and reuse filters.

## Clog Removal

**Always unplug vacuum from outlet before removing any clogs!**

**NOTE! K3 users with ETH, ET1 or ET2 power heads, please refer to your power head user's manual for more detailed instructions for removing clogs in your power head.**

**If the bag full or clog warning light (10) remains illuminated after the filter bag has been changed and the filters are in good condition, there is likely a clog in the system.**

### Clogs in the Head or Brush

Clogs in the swivel neck (57) of a head or brush can be cleared by first pressing the tool release button (7) and removing the brush or head. Check inside the swivel neck channel (56), and clean out pathway.

### Clogs in the Telescopic Tube

Remove head from telescopic tube (4) by pushing the tool release button (7) and pulling the tube out. Remove the hose from the top of the telescopic tube by pushing the handle release button (3). A stiff wire or stick can be used to push the clog out of the tube.

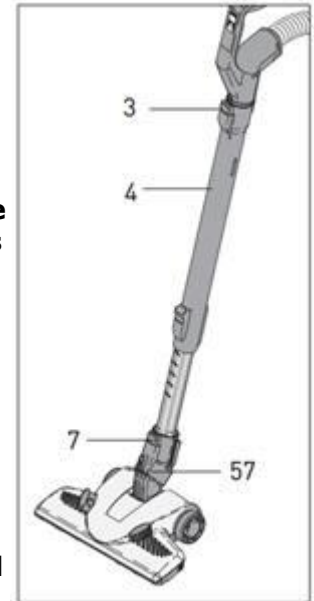
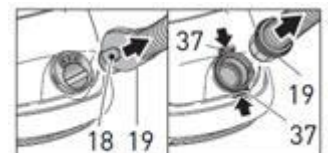

Figure 20

### Clogs in the Hose

Check for suction at the end of the hose (19). If you feel reduced suction, the blockage is in the hose. To clear blockages in the hose (13), remove the telescopic tube (4) by pushing the tool release button (7) and pulling the tube out. Hold the hose upright with one hand blocking the top and switch on the machine. If necessary, quickly lift your hand on and off the end of the hose. If that does not clear the clog, you may also clear clogs by reversing the hose. K3: After removing the telescopic tube, push the release button (18) on the hose neck (6) and remove the hose from the machine. K2: After removing the telescopic tube, squeeze the tabs (37) on the retaining ring and pull the hose neck out. Remove the hose handle (1) from the telescopic tube by pressing the handle release button (2). Insert the handle end of the hose (1) into the suction opening (17). Hold the hose upright with one hand blocking the top and switch on the machine. If necessary, quickly lift your hand on and off the end of the hose.

**Note:** Do not insert a wire or stick into the hose. Doing so may cause damage to the hose.



K3 Figure 21 K2

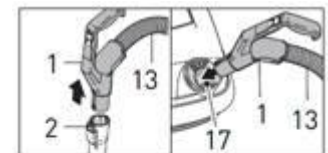

Figure 22

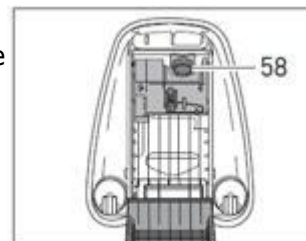

Figure 24



Figure 23

### Clogs in Entrance to Filter Bag

Remove hose (10) cover and remove the filter bag (figure 16, page 9). Clean out entrance to bag (58).

Remove hose (10) cover and remove the

## Troubleshooting Guide

**Always unplug vacuum from outlet before dismantling any part of the machine!**

Problem	Reason(s)	Solution
Does not turn on.	1. Telescopic tube not inserted properly	See Page 7
	2. Not plugged into working outlet	Use another outlet
	3. Cable worn	Replace cable
	4. K3: Power control	K3: Set slide switch to "on" position.
Bag full/clog light on and/or machine shuts off.	1. Bag full	Replace filter bag
	2. Clog in hose, telescopic tube, brush or head, or entrance to filter bag.	See "Clog Removal"
	3. Micro-hygiene filter dirty	Replace micro-hygiene filter
	4. Exhaust filter dirty	Replace exhaust filter.
Does not pick up.	1. Hose/handle assembly not correctly inserted	Reinsert hose/handle assembly making sure that it is lined up properly and is snapped into place.
	2. The suction control dial is rotated to no suction setting	K2: Rotate suction control dial to yellow setting.
	3. Filter bag cover not closed	3. See below.
Filter bag door won't fully close.	1. Filter bag cover not fully closed	Reinsert bag. Lock the cover down firmly.
	2. Bag not inserted properly.	Reinsert bag. Lock the cover down firmly.
	3. Micro-hygiene filter not properly inserted.	Remove the filter bag cover and make sure the micro-hygiene filter housing is seated firmly in place.

## Warranty Information

### Five Year Non-Wear Parts - Five Years Motor - One Year Labor

1. Your authorized Sebo dealer or Sebo will provide the original product purchaser with replacement of non-wear parts which fail due to a material or workmanship defect for a period of five (5) years from the original date of purchase of new product. Sebo America will provide a five (5) year warranty on suction motors and brush drive motors.
2. Your authorized Sebo dealer or Sebo will repair (or will cover labor charges associated with repair) a defected Sebo vacuum cleaner at no cost to the original purchaser, within one (1) year of original purchase of new product.
3. Sebo America or an authorized Sebo dealer must complete all warranty repairs.
4. To locate an authorized Sebo dealer in your area, or to register a warranty claim in the **United States of America**, please visit [www.sebo.us](http://www.sebo.us)

5. To locate an authorized Sebo dealer in your area, or to register a warranty claim in **Canada, please call Floor Care Equipment, Ltd. at 403-250-5005**

6. The warranties provided for above apply exclusively to Sebo vacuum cleaners which are used residentially. No warranty is provided for Sebo vacuum cleaners used commercially.

7. The Wear Parts excluded from warranty coverage include filter bags, micro-hygiene filters, exhaust filters, the cable (external cord), the attachment hose, the brush rollers, the front bottom plate, the rear bottom plate, the telescopic tube, the crevice nozzle, the upholstery nozzle, the dusting brush and all of the optional attachments.

8. This warranty applies only while your Sebo vacuum cleaner is physically located within the United States of America and its territories or Canada.

9. The purchase receipt showing the date, price, and item of purchase is the initial document of proof of purchase and determines the validity of warranty. To be certain that your warranty claim can be processed as quickly and efficiently as possible, please retain your original purchase receipt and mail in the warranty card provided with your new Sebo vacuum cleaner. You may also register on our website at [www.sebo.us](http://www.sebo.us)

10. This warranty gives you specific legal rights. You may also have other legal rights, which vary from state/province to state/province.

11. Sebo America will not process nor will it accept responsibility for warranty claims for machines purchased from dealers located in Canada. Floor Care Equipment, Ltd. will not process nor will it accept responsibility for warranty claims for machines purchased from dealers located in the United States.

**EXCLUSIVE REMEDY:** The remedies provided under the terms of this warranty are the purchaser's exclusive remedies and are in lieu of any other remedies otherwise available.

**THE WARRANTY DOES NOT COVER:**

- Used or secondhand products.
- Products outside of the warranty period.
- Items not manufactured by Sebo.
- Normal maintenance service.
- Equipment damaged by improper use, accident, other casualty or negligence.
- Machines equipped with non-authorized attachments or modifications.
- Machines on which the serial number has been altered or removed.

**Limitations and exclusions:**

Sebo makes no other representations or warranties, expressed or implied and specifically excluded the implied warranties of merchantability and fitness for a particular purpose.

Sebo will not be liable for incidental or consequential damages of any kind or nature.

This disclaimer of implied warranties shall not apply to the extent said disclaimer is not allowed by applicable state/provincial law.

**To contact Sebo in the United States:**

Sebo America, LLC  
Telephone: 303-792-9181  
Fax: 303-792-9196  
Website: [www.sebo.us](http://www.sebo.us)

© Copyright Sebo America, LLC - All Rights Reserved

[Return to Top](#)